



VRLA Battery **SVTX 450**

Specifications

Nominal Voltage 2 V

| Rated Capacity (20 °C) | 20hr Rate (1,80V/cell) | 10hr Rate (1,80V/cell) | 5hr Rate (1,70V/cell) | 1hr Rate (1,60V/cell) | | |
|-----------------------------------|------------------------|------------------------|-----------------------|-----------------------|--------|--|
| | 468 Ah | 450 Ah | 412,5 Ah | 298 Ah | | |
| Dimensions (mm) & Weight (kg) | Length | Width | Height | Overall Height | Weight | |
| | 208 mm | 201 mm | 263 mm | 272 mm | 28 kg | |
| Number / Type of Terminals | 4 / M8 | | | | | |

Technical Characteristics

| | |
|--|---|
| Design Life at 20°C | 15 years |
| Eurobat Classification | Long Life |
| Internal Resistance (Fully charged -25°C) | 0,22 mΩ |
| Short-circuit current | 9600 A |
| Max Charging Current | 135 A |
| Min safe end Discharge Voltage | 1,60 V/cell |
| Self discharge per month at 20°C | 3% |
| Recommended Charging Voltage at 20°C | Stand-by use (V/cell): 2,25 to 2,30 Cycle use (V/cell): 2,40 to 2,50 |
| Container Material | ABS-UL94 HB |
| Electrolyte Type | Sulfuric Acid |
| Type of plates / Alloy | Flat plates / Lead-Calcium-Tin alloy |
| Type of Separator | Absorbant Glass Mat |
| Valve Type / Operational Pressure | Rubber / 1-3 psi (70-200 mbar) |
| Operating Temperature Range | -20 to 50°C |
| Storage time at 20°C | 9 months |

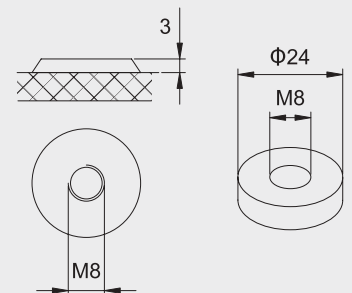
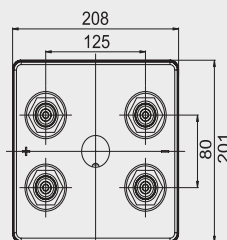
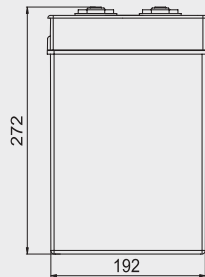
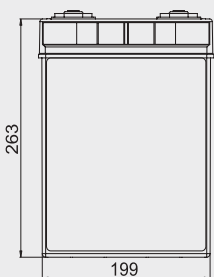

GERMANOS S.A.
23rd klm. National Road Athens-Lamia
145 65 Ag. Stefanos Attica, Greece
Tel.: +30 210 6242000
Fax: +30 210 6216911

SUNLIGHT Manufacturing Plant
Neo Olvio
67 200 Xanthi, Greece
Tel.: +30 25410 48100
Fax: +30 25410 95446

 **SUNLIGHT**
creating energy
www.sunlight.gr