



# VRLA Battery **SVTX 280**

## Specifications

**Nominal Voltage** 2 V

Rated Capacity (20 °C)	20hr Rate (1,80V/cell)	10hr Rate (1,80V/cell)	5hr Rate (1,70V/cell)	1hr Rate (1,60V/cell)	
	288 Ah	280 Ah	256 Ah	188 Ah	
Dimensions (mm) & Weight (kg)	Length	Width	Height	Overall Height	Weight
	208 mm	135 mm	263 mm	272 mm	17,5 kg

**Number / Type of Terminals** 2 / M8

## Technical Characteristics

<b>Design Life at 20°C</b>	15 years
<b>Eurobat Classification</b>	Long Life
<b>Internal Resistance (Fully charged -25°C)</b>	0,35 m!
<b>Short-circuit current</b>	5900A
<b>Max Charging Current</b>	84A
<b>Min safe end Discharge Voltage</b>	1,60 V/cell
<b>Self discharge per month at 20°C</b>	3%
<b>Recommended Charging Voltage at 20°C</b>	Stand-by use (V/cell): 2,25 to 2,30 Cycle use (V/cell): 2,40 to 2,50
<b>Container Material</b>	ABS-UL94 HB
<b>Electrolyte Type</b>	Sulfuric Acid
<b>Type of plates / Alloy</b>	Flat plates / Lead-Calcium-Tin alloy
<b>Type of Separator</b>	Absorbant Glass Mat
<b>Valve Type / Operational Pressure</b>	Rubber / 1-3 psi (70-200 mbar)
<b>Operating Temperature Range</b>	-20 to 50°C
<b>Storage time at 20°C</b>	9 months

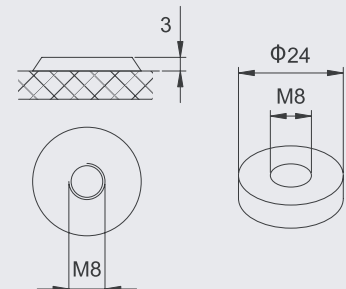
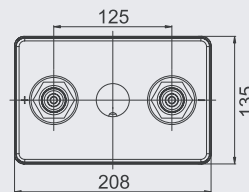
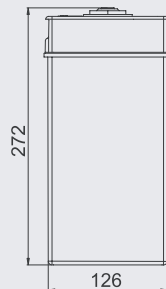
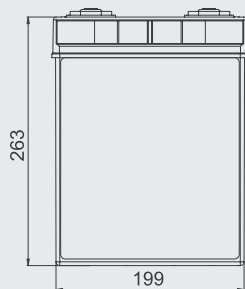

**SUNLIGHT SYSTEMS S.A.**  
**Headquarters**  
 23rd km. N.R. Athens-Lamia  
 145 65 Ag. Stefanos, Attica, Greece  
 Tel.: +30 210 6242000  
 Fax : +30 210 6216911

**Manufacturing Plant**  
 Neo Olvio  
 67 200 Xanthi, Greece  
 Tel.: +30 25410 48100  
 Fax : +30 25410 95446

 **SUNLIGHT**  
 creating energy  
[www.sunlight.gr](http://www.sunlight.gr)